



JS00 JS10 JS20 JS50

Size <ligne>	12 ½'''
Height <mm>	4.13
Accuracy <per Month>	±20 sec
Battery Life	3 years

*30 minutes chronograph operation per day

Battery consumption could be minimum by pulling out the stem

Balance Weight <μN · m>	Minute 0.40 Second 0.09 Small 0.02
----------------------------	--

Featured by Shock Detection

Clearance	
-----------	--

Original Package	500 pcs
------------------	---------

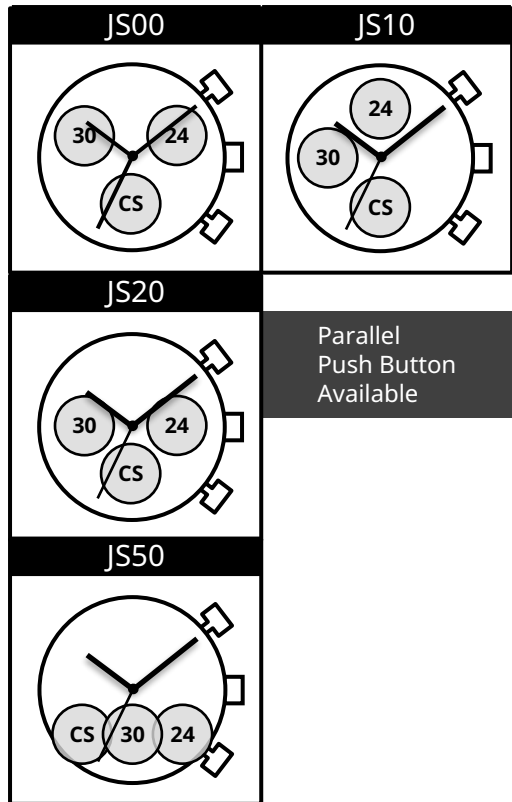
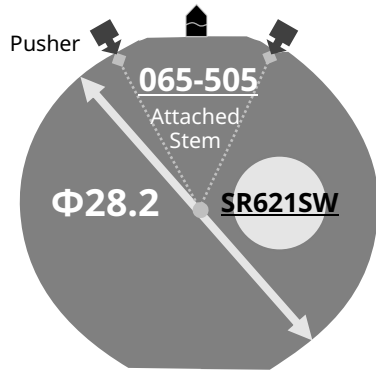

Time measurement Accuracy

The unit (gate) time of measurement must be set at "10 sec." and the measurement must be performed in the form of complete watch.



Push "A"
Start and Stop the chronograph

Setting the Time

Set CHRONOGRAPH hands to reset

Push "B"
Reset the chronograph

Push A to reset the hands position to the ZERO position. And continue to push A to put them forward

Assembly - Disassembly chart for Cal. JS50

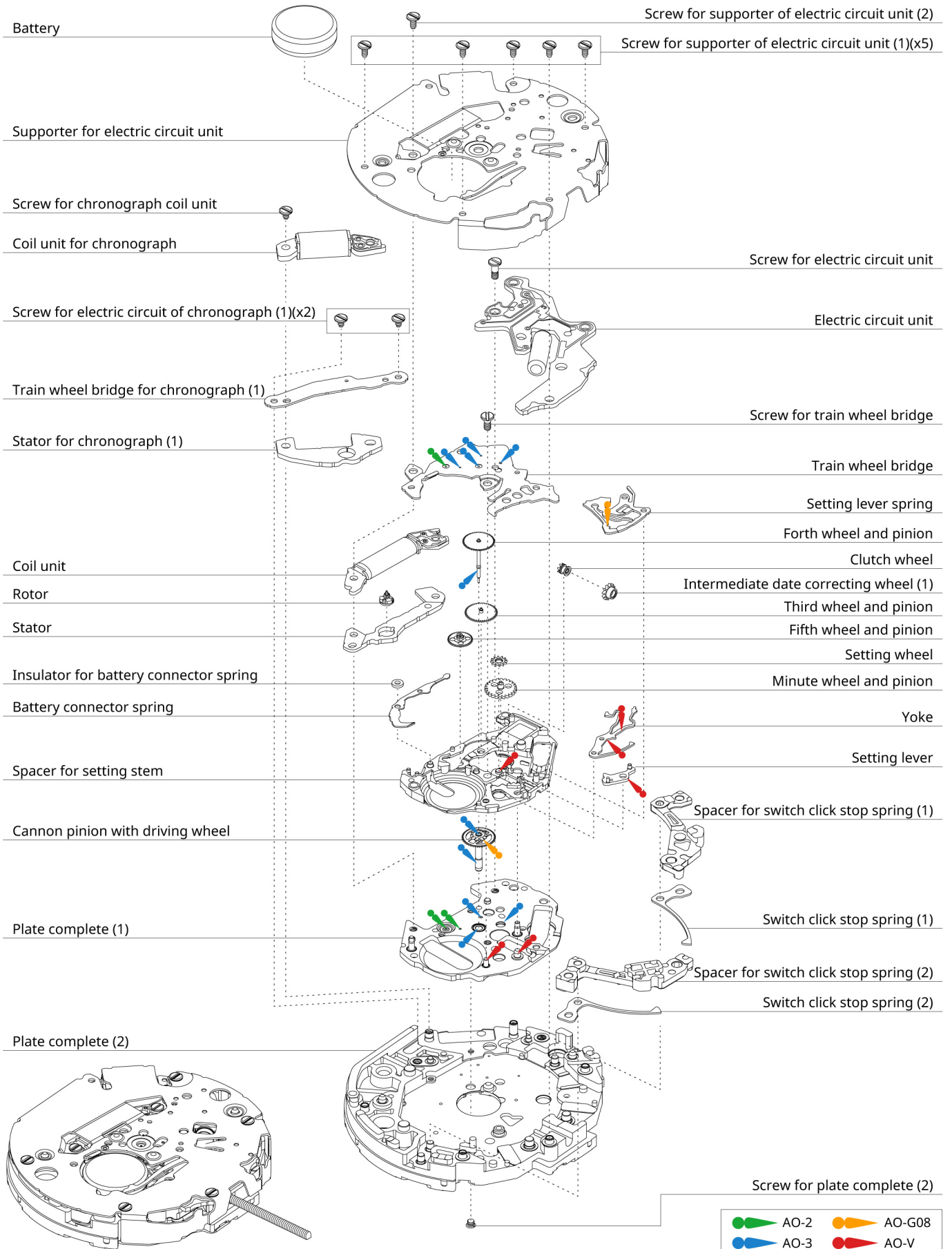

Assembly - Disassembly chart for Cal. JS50

