



JS05 JS15 JS25 JS36

Size <ligne>	12 ½"
Height <mm>	4.30
Accuracy <per Month>	±20 sec
Battery Life	3 years

*60 minutes chronograph operation per day

Battery consumption could be minimum by pulling out the stem

Balance Weight <μN·m>	Minute 0.40 Second 0.09 Small 0.02
--------------------------	--

Featured by Shock Detection

Clearance	<p>Hand clearance: 0.45mm min. Movement clearance: 0.15 ~ 0.65mm</p>
-----------	--

Original Package	500 pcs
------------------	---------

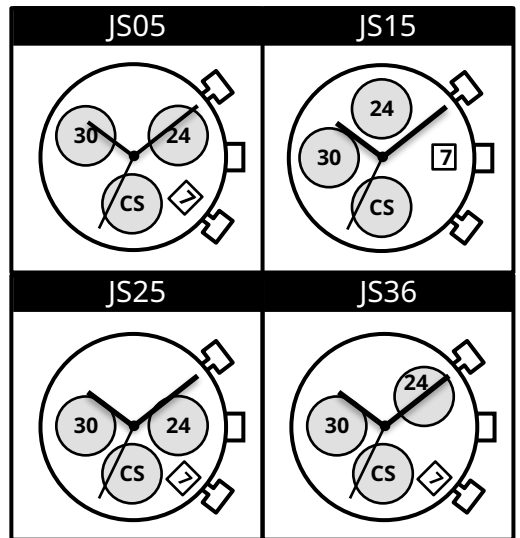
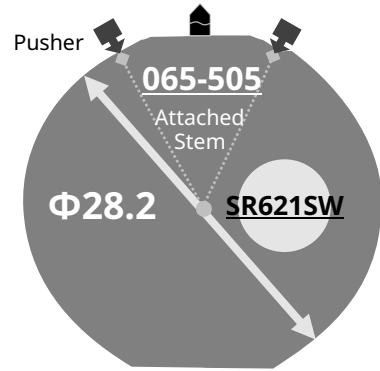

High Hand Ver.
JS06
JS16
JS26
JS36

Time measurement Accuracy

The unit (gate) time of measurement must be set at "10 sec." and the measurement must be performed in the form of complete watch.

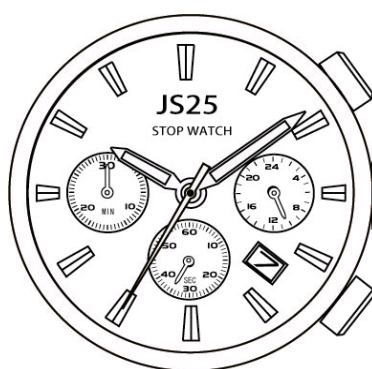

Push "A"
Start and Stop the chronograph

Setting the Time

Set CHRONOGRAPH hands to reset

Push A to reset the hands position to the ZERO position. And continue to push A to put them forward

Setting the Date

Push "B" DO NOT set Date between 9:00pm - 1:00am

Reset the chronograph

Assembly - Disassembly chart for Cal. JS26

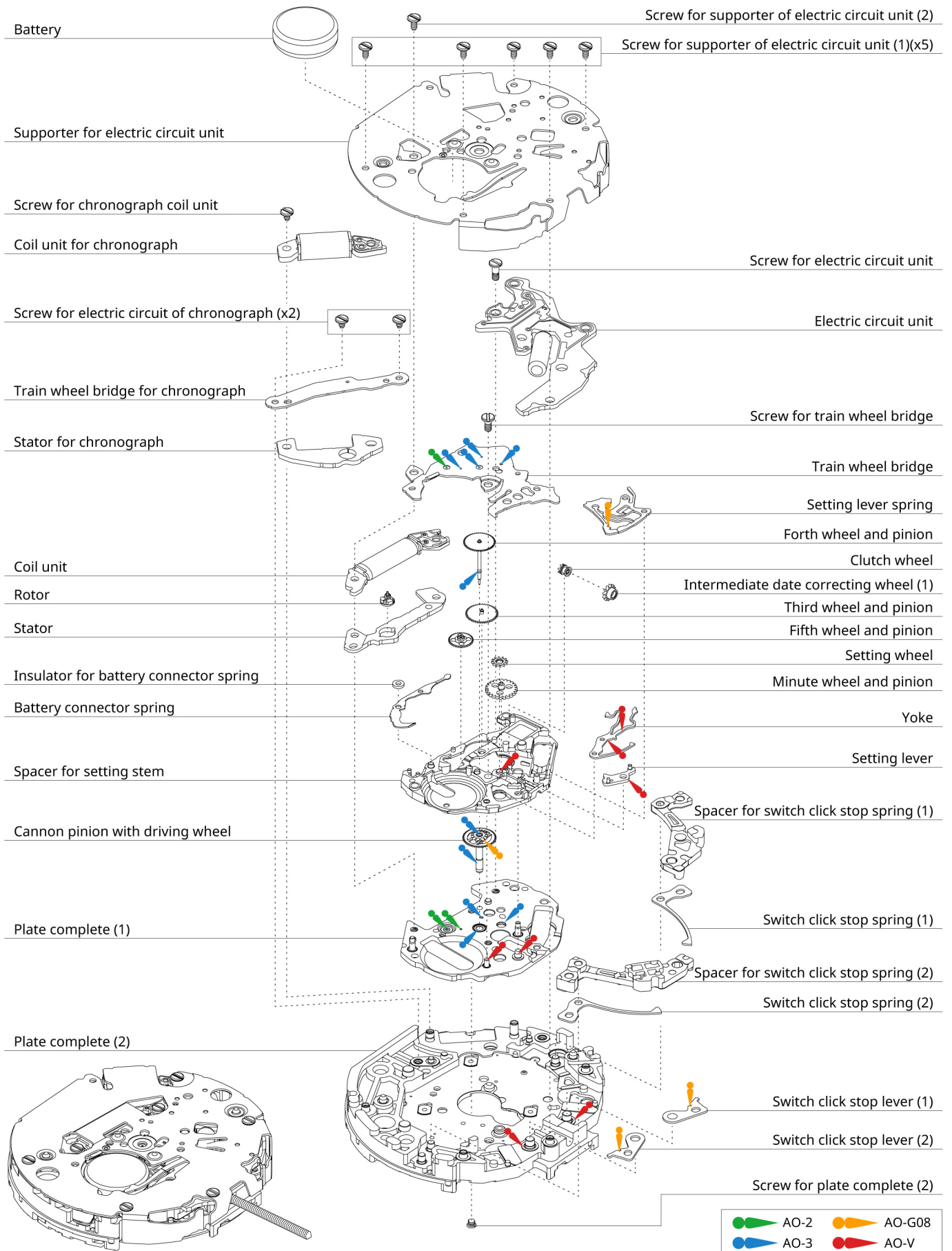

Assembly - Disassembly chart for Cal. JS26

