

**9100 9120 9122 9132 9133**

Size <ligne>	13 ½'''
Height <mm>	5.52
Accuracy <per Day>	-10 ~ +30 sec
Posture Difference	(under) 30 sec
Running Time	(more than) 40 hours
Vibration Frequency <per Hour>	(vibration) 28800
Clearance	 <p>case</p> <p>Hand</p> <p>Movement</p> <p>0.40mm min.</p> <p>0.40mm min.</p> <p>Clearance changes subject to the glass, case structure, and the length of the hand.</p>
Jewels	26 pcs
Lift Angle	51 degree
Original Package	100 pcs

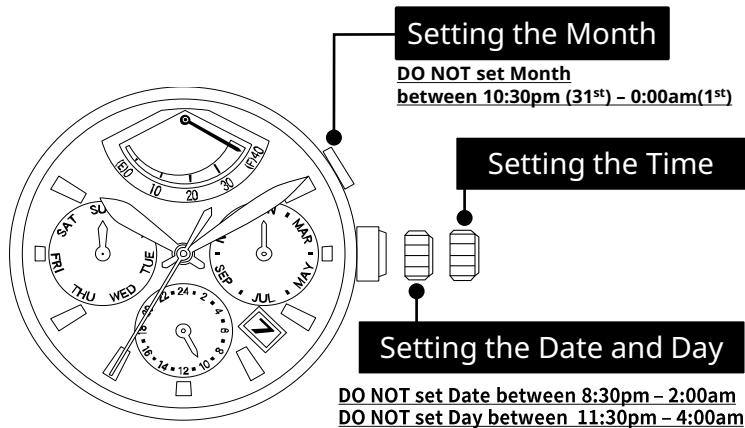
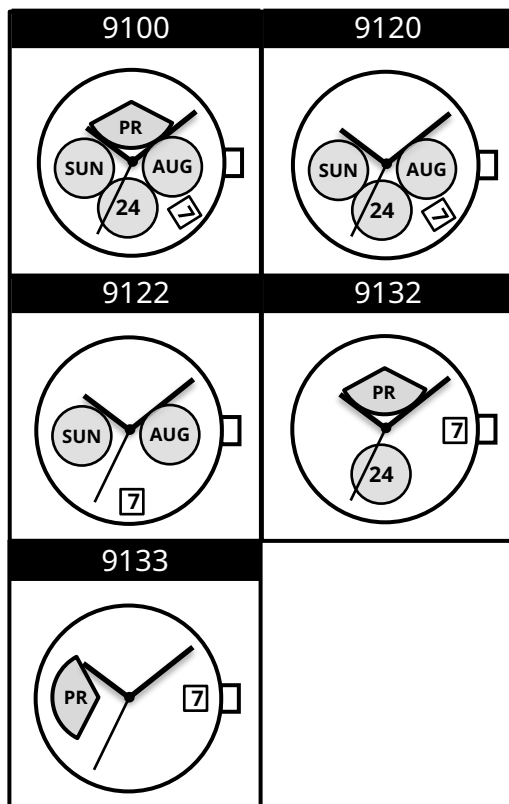
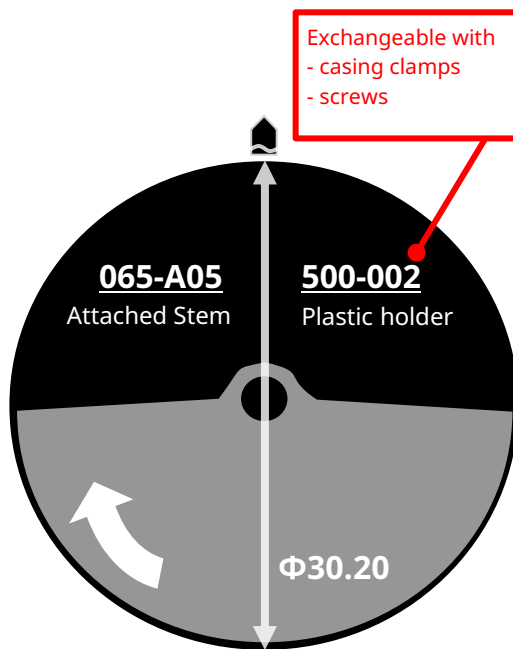

# INFORMATION

## Time measurement & Winding

### Mechanical

#### Accuracy

Measure within lapse of 10~60 minutes from full winding with ① posture.

#### Posture difference

Measure accuracy in below ①~④ postures.

- ① Dial side up
- ② 6 o'clock side up
- ③ 9 o'clock side up
- ④ 3 o'clock side up

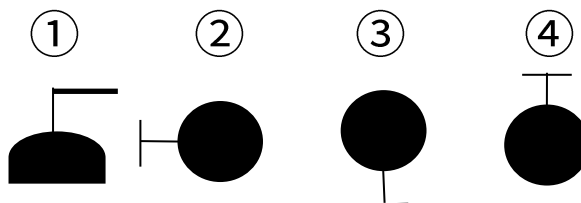

#### ■ To make full-winded

90 / 91	Turn the crown 40 times
82 / 8N	Turn the crown 40 times
6T	Turn the crown 20 times

#### ■ Winding direction

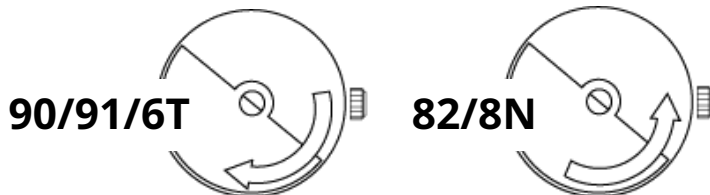

## Assembly - Disassembly chart for Cal. 9133

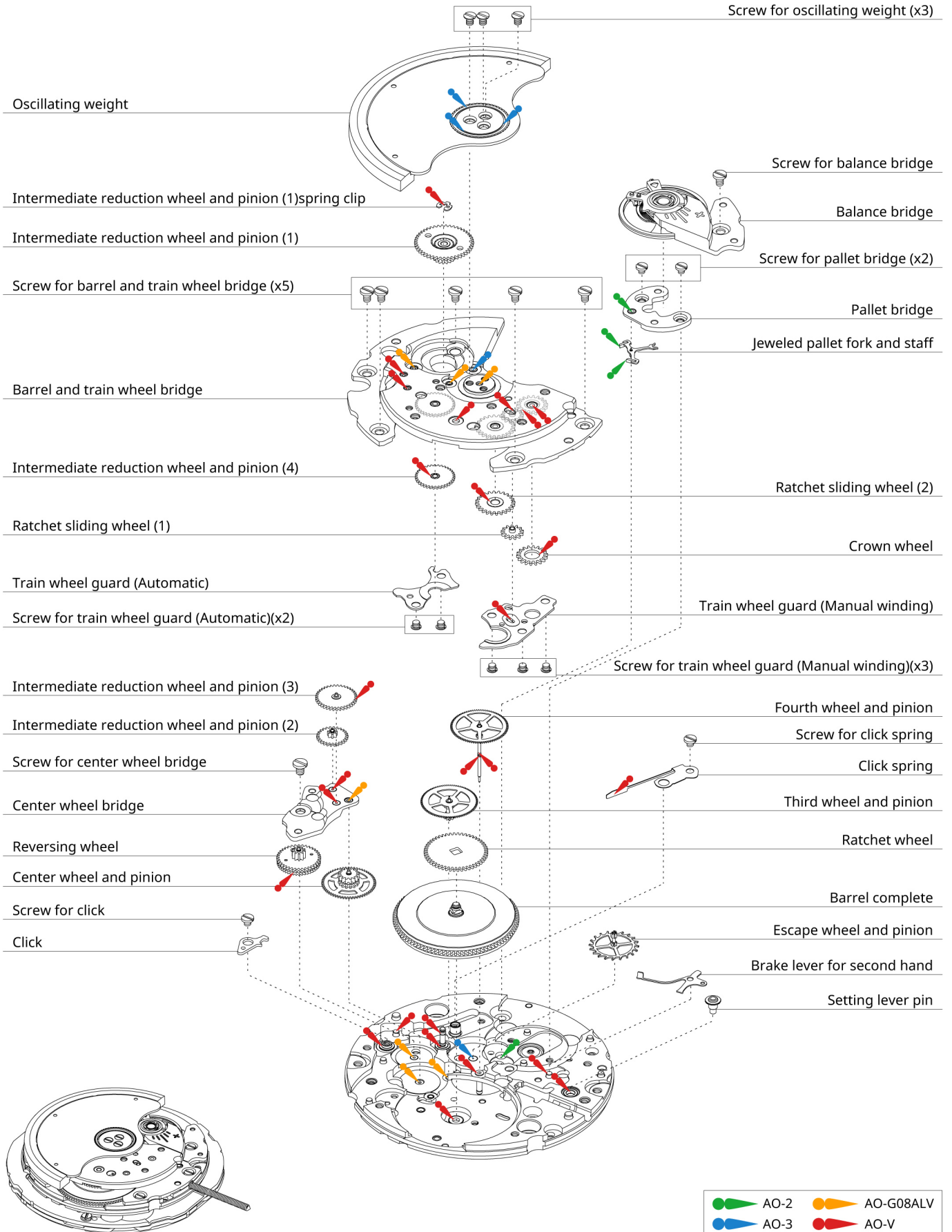

## Assembly - Disassembly chart for Cal. 9133

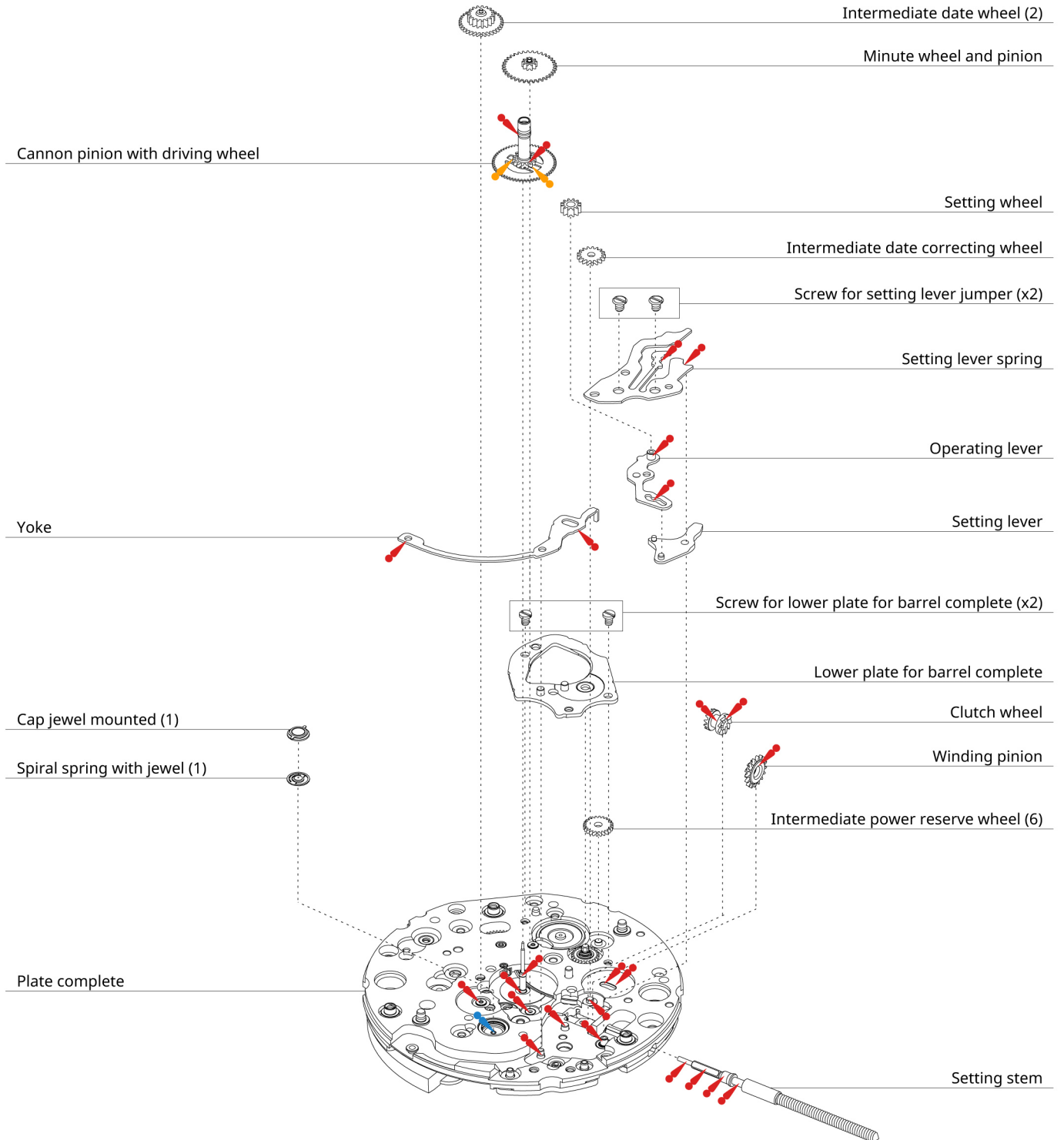

### Assembly - Disassembly chart for Cal. 9133

