

# 9039

Size <ligne>	11 ½'''
Height <mm>	3.90
Accuracy <per Day>	-10 ~ +30 sec
Posture Difference	(under) 30 sec
Running Time	(more than) 42 hours
Vibration Frequency <per Hour>	(vibration) 28800
Clearance Clearance changes subject to the glass, case structure, and the length of the hand.	 <p>case Hand ↑ 0.40mm min. Movement ↓ 0.40mm min.</p>
Jewels	24 pcs
Lift Angle	51 degree
Original Package	100 pcs

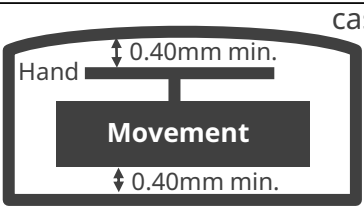
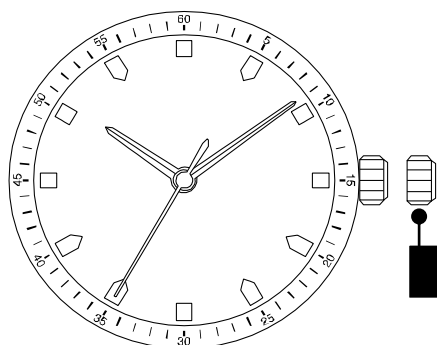
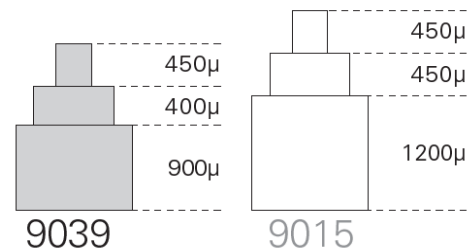
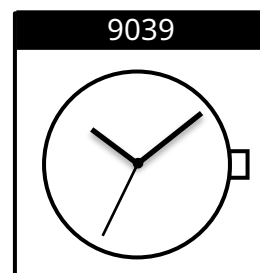
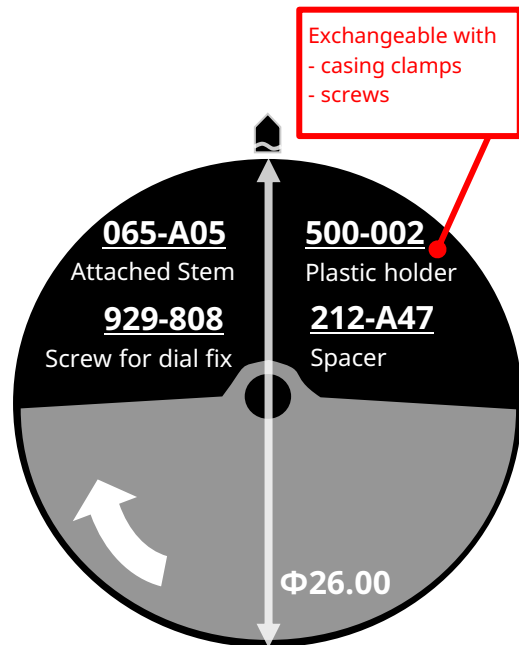

Setting the Time

# INFORMATION

## Time measurement & Winding

### Mechanical

#### Accuracy

Measure within lapse of 10~60 minutes from full winding with ① posture.

#### Posture difference

Measure accuracy in below ①~④ postures.

- ① Dial side up
- ② 6 o'clock side up
- ③ 9 o'clock side up
- ④ 3 o'clock side up

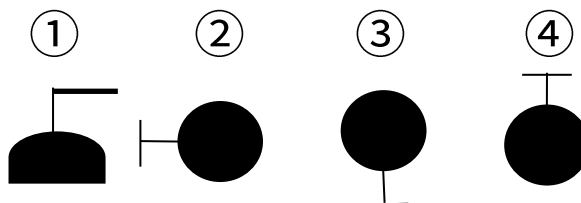

#### ■ To make full-winded

90 / 91	Turn the crown 40 times
82 / 8N	Turn the crown 40 times
6T	Turn the crown 20 times

#### ■ Winding direction

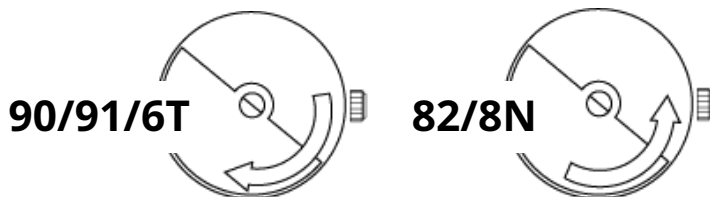

## Assembly - Disassembly chart for Cal. 9039

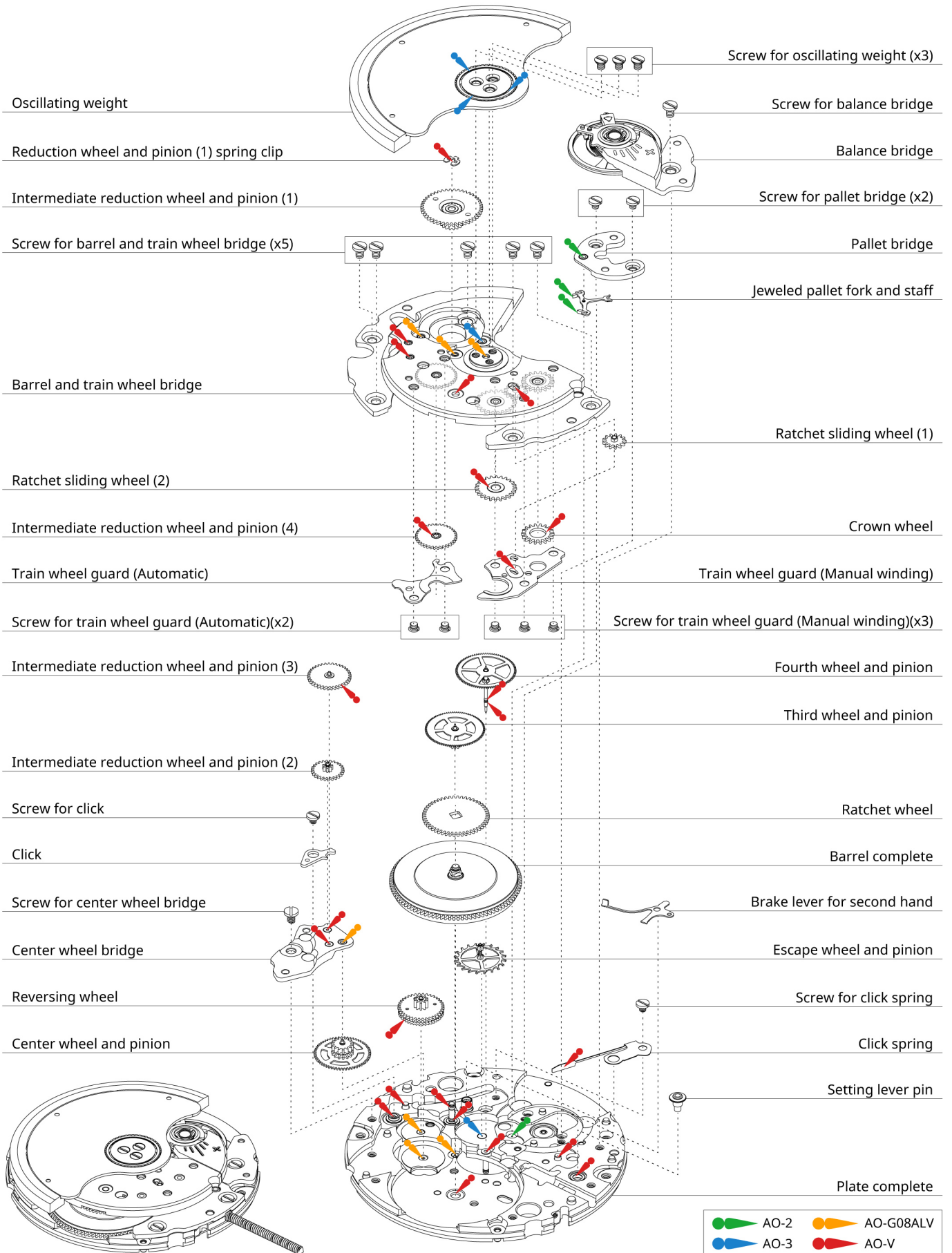

## Assembly - Disassembly chart for Cal. 9039

