

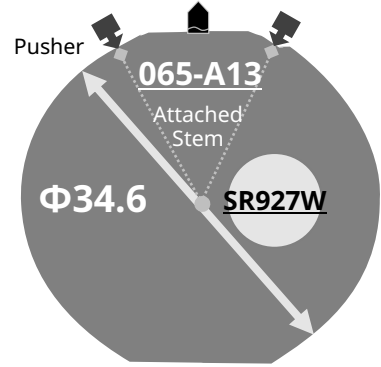

6S10 6S20 6S30 6S11 6S21

Size <ligne>	15'''
Height <mm>	4.90
Accuracy <per Month>	±20 sec
Battery Life	4 years (6S21 3 years)



Battery consumption could be minimum by pulling out the stem

Balance Weight <μN · m>	Minute 1.00 Second 0.40 Small 0.04
----------------------------	--

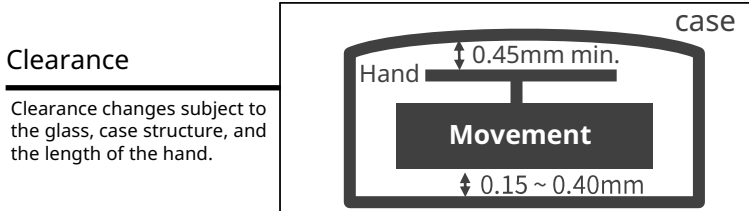

Original Package	200 pcs
------------------	---------

Time measurement Accuracy

The unit (gate) time of measurement must be set at "10 sec." and the measurement must be performed in the form of complete watch.

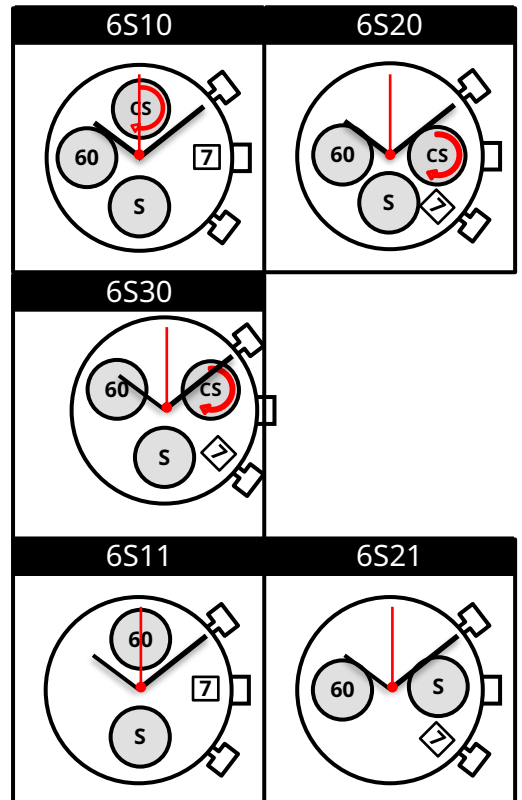

Push "A"
Start and Stop the chronograph

Setting the Date
DO NOT set Date between 9:00pm - 1:00am

Push "B"
Reset the chronograph

Setting the Time

Set CHRONOGRAPH hands to reset

Push A or B to set the hands to the zero position. The chronograph hands can be advanced rapidly by continuously pressing button. A for the Center Chronograph Second hand, B for 1/20 hands

Assembly - Disassembly chart for Cal. 6S10

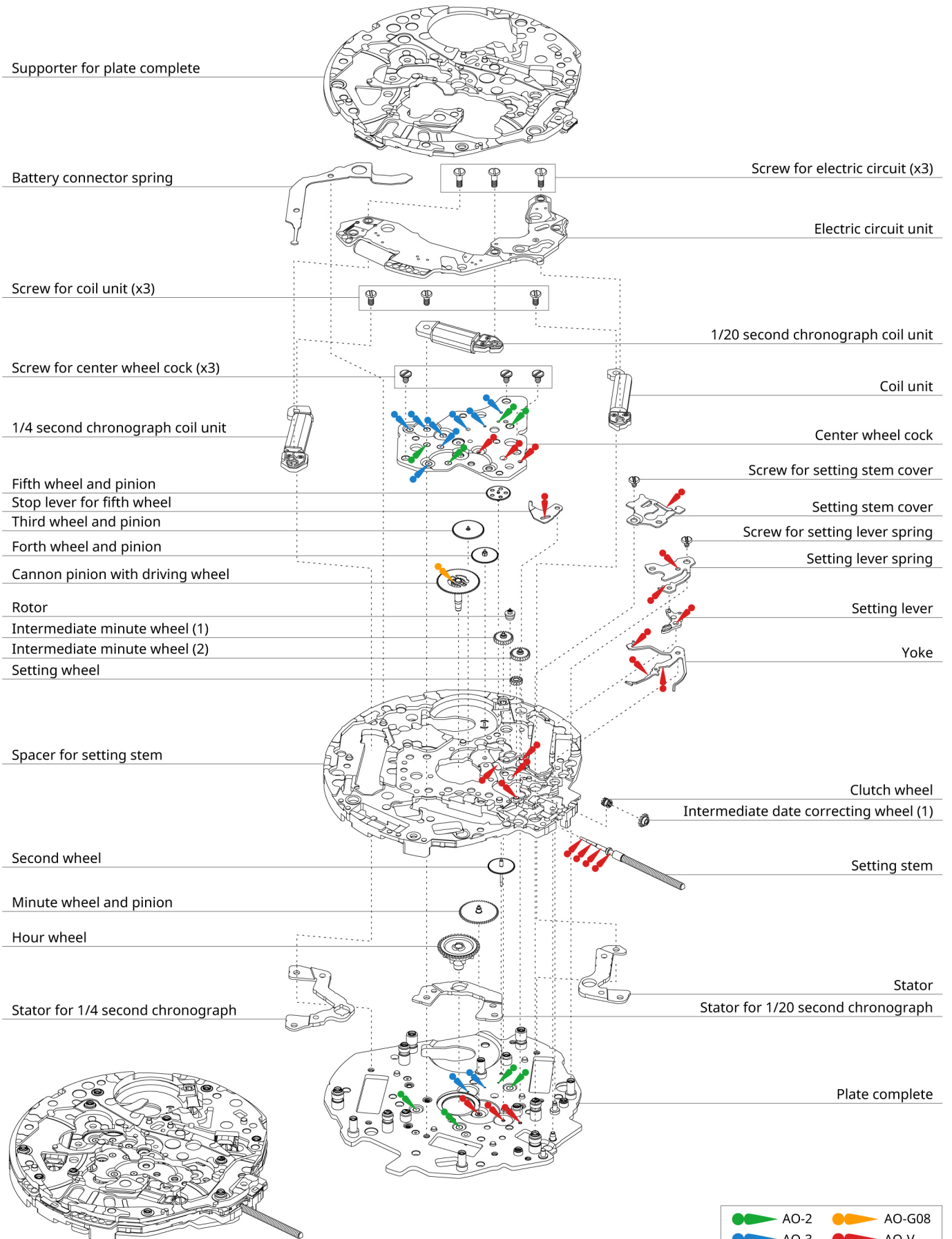

Assembly - Disassembly chart for Cal. 6S10

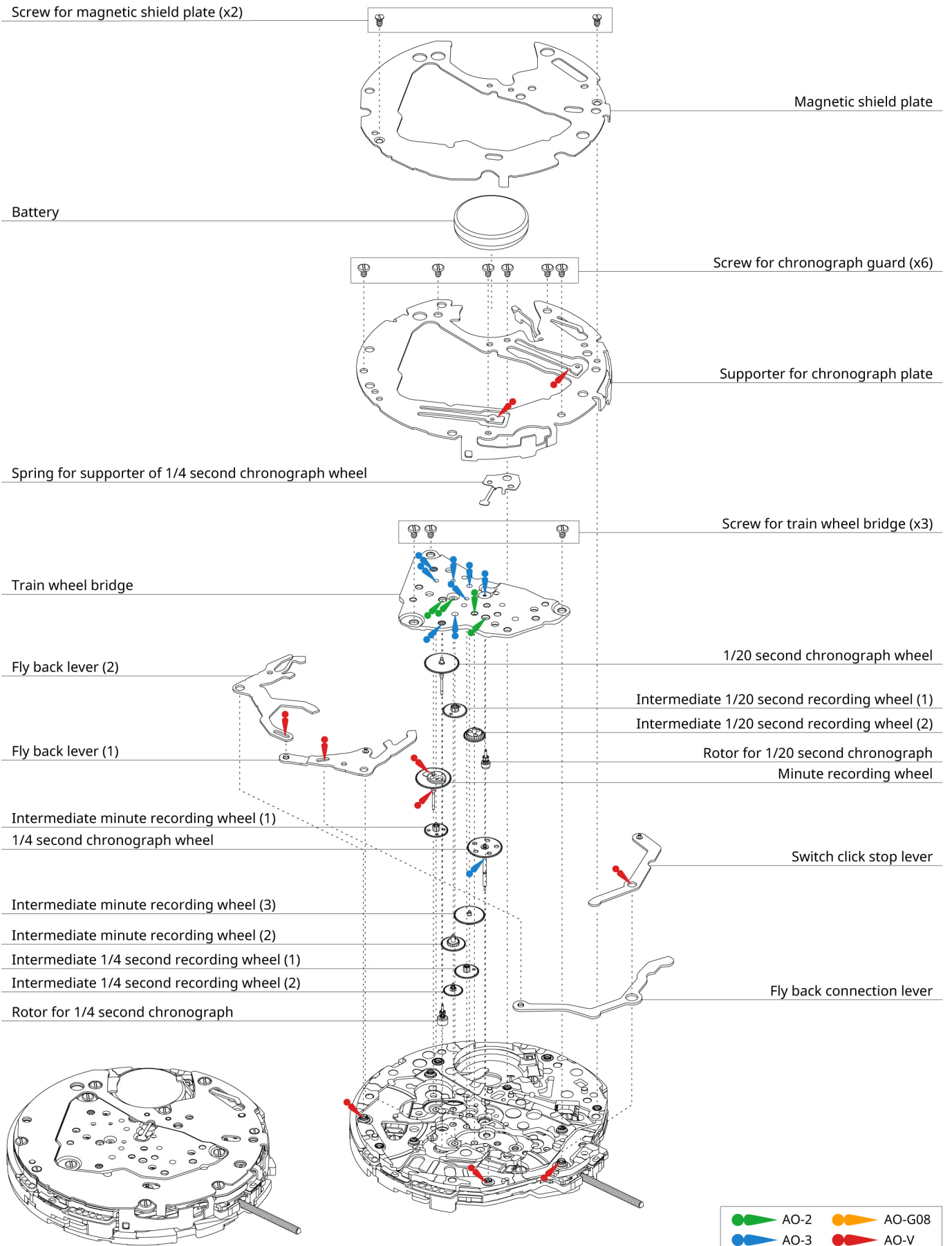



Assembly - Disassembly chart for Cal. 6S10

Screw for date dial guard (x3)

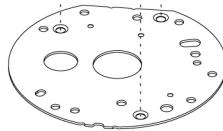

Date dial guard

Date dial

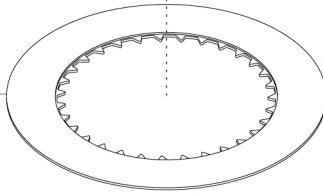

Date dial driving wheel



Date jumper



Calendar corrector wheel



Intermediate date correcting wheel (5)



Screw for calendar plate (x3)



Calendar plate

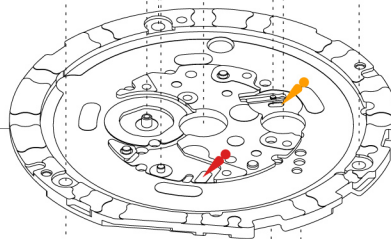

Intermediate date correcting wheel (3)



Intermediate date correcting wheel (4)



Intermediate date correcting wheel (2)

